

# MS30

## Ultra Thin

Series

Ultra thin magnetic track lighting system is easy to install and doesn't require any false ceiling, slim design of 5mm thick track can be easily mounted on any hard surface like wooden and concrete style, Light modules are compact with sufficient power. smart light modules options are available to create ambiance according to mood. Available in Black and White body colours options.



# Installation Instruction for ULTRA THIN MAGNETIC TRACK

## Step 01



Drill proper holes on the ceiling in the size which is according to the expansion pipe. In addition, the position of the holes should according to the holes on junction box, and the reserved wire should be in the middle of the holes.

**Remark:** If the reserved wire can not be in the beginning of the track, it can also be conduct under the iron bracket to the junction box.

## Step 03

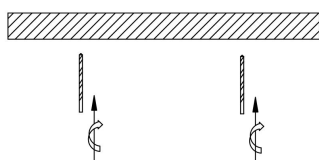

Drill proper holes on the ceiling in the size which is according to the expansion pipe. In addition, the position of the holes should according to the holes on iron bracket, and the first track should be in line with the junction box.

## Step 05

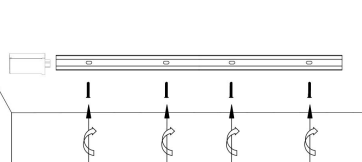

Fix the iron bracket on the ceiling by twisting the self-tapping screws through the holes of the bracket into the expansion pipes.

## Step 07

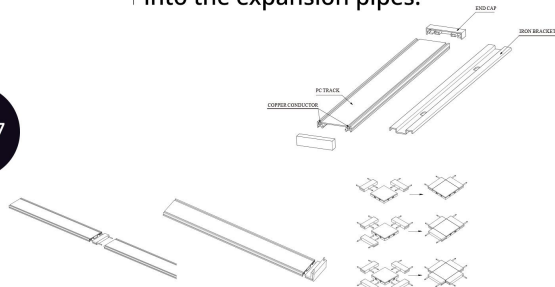

In order to make long version or different shapes of tracks, insert the pin of the connectors in the hole under the copper conductor. Straight connect, 'in' corner and 'L' 'T' & '+' shape corners are all available in the same way.

## Step 09

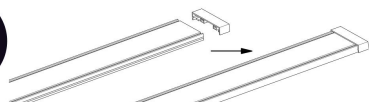

Fix the end cap into the last track.

## Step 02

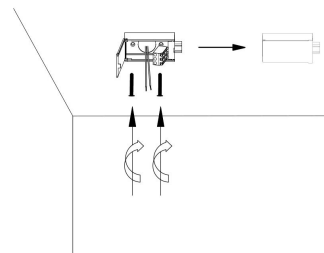

Open the junction box and pull the wire out through the big hole of the junction box then fix the junction box on the ceiling by twisting the self-tapping screws through the holes of the box into the expansion pipes. Later connect the wire to the terminal and close the box.

**Remark:** 1. While connecting, please ensure the electricity of the wire is off. 2. The yellow one in the middle of the terminal is for earth, another two for N&L. 3. The junction box is in the beginning and will be in same line with the first track

## Step 04

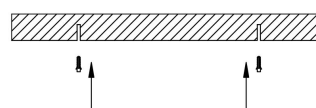

Put the expansion pipe in the drilled holes.

## Step 06

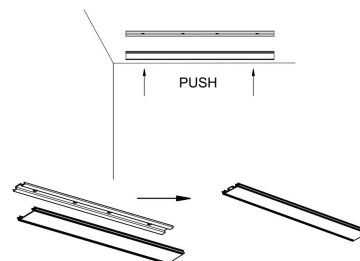

Fix the pc track on the iron bracket by pushing.

## Step 08

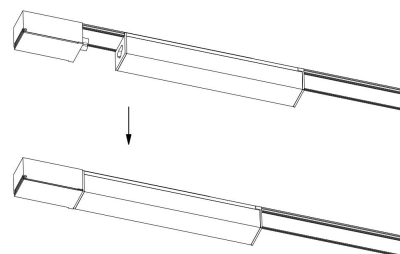

Put the power supply on the track and connect to the junction box, make sure it's connected well.

## Step 10

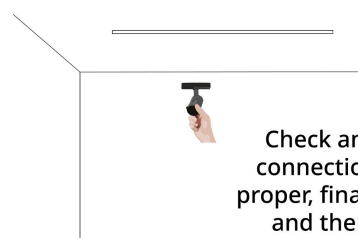

Check and confirm if all the connections of the tracks are proper, finally give the electricity and then install the lights.







# WIFI Remote Control and Manual

Model No.  
& Power (W)

Picture

Description

Price

SMART/TUYA/REMOTE



Remote to operate wifi enabled lights and driver, works on smart home app, with wifi and location. It can be used to tune and dim the lights, also can set modes. Works with two AAA batteries.

₹1,680



## TUYASMART APP.CONTROL:

TuyaSmart App enables thr lamps to be controlled remotely through the net work.After registering and logging,you can manage the lamps at any time

- 1 Download and open the TuyaSmart app,open the bluetooth of the mobile phone,and connect to the Wifi of the zone.
- 2 Only if the lamp flashes when power on is the matching state
- 3 Reset:Power on and off the powersupply 8 times till the lamps flashes (note:after power off it need wait unless 2 seconds each time to empty the electricity)

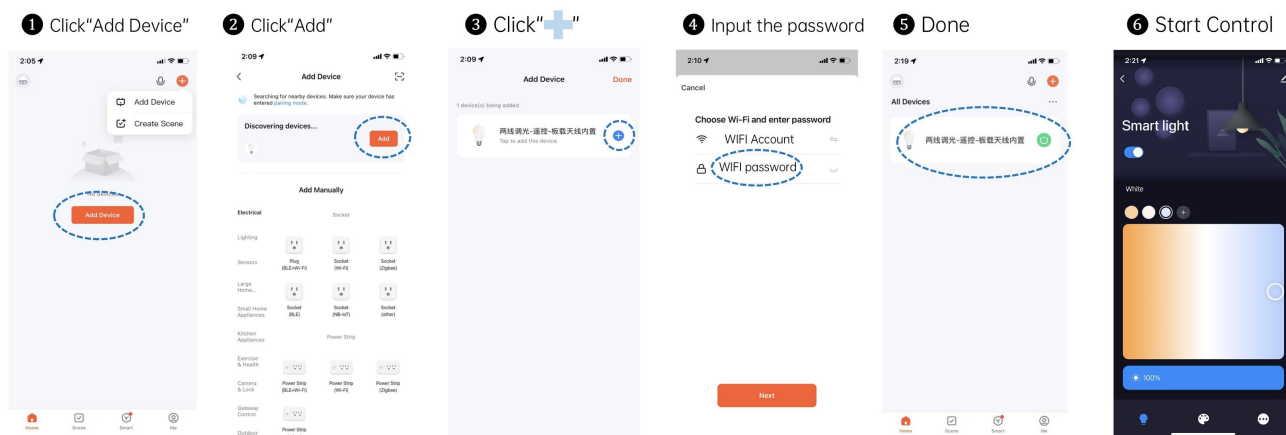

★Note:If can not find the device,please reset.

## MANUAL FOR TUYA WIFI REMOTE CONTROL:

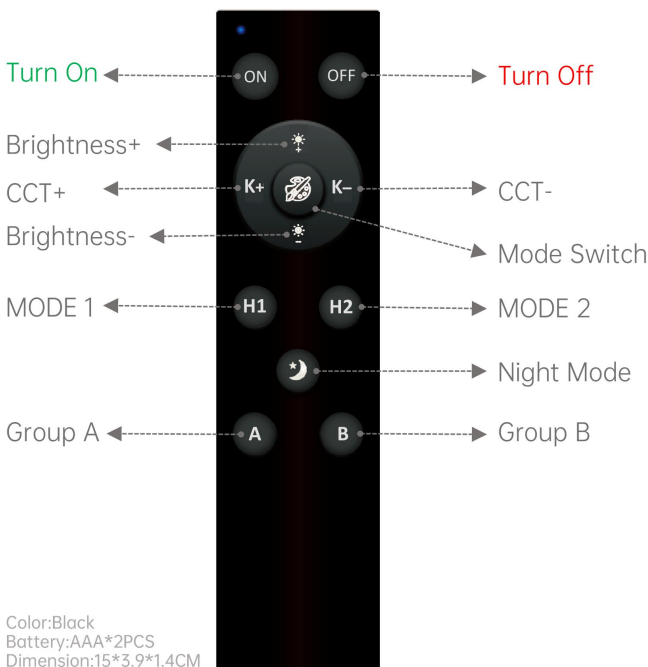

- 1 Pair:In 3-10 seconds after Turn on, hold the ON button (A or B) till the lamp flashes,then matches successfully
- 2 Group Reset:Hold the A or B button and Brightness decrease button together for 5 seconds,unpair group A or B
- 3 Whole Reset:Hold the ON button and Brightness decrease button together for 5 seconds;unpair all the lights

Button Option	
ON	Turn On (all the lights connected)
OFF	Turn Off (all the lights connected)
Scene Mode	Scene Mode (Mode Switch)
Brightness Increase	Brightness Increase ▲
Brightness Decrease	Brightness Decrease ▼
CCT+	CCT Increase ▲
CCT-	CCT Decrease ▼
H1	MODE1 (Hold to save the current scene,press to turn on the saved scene)
H2	MODE2 (Hold to save the current scene,press to turn on the saved scene)
Night Mode	Night Mode (3000K Brightness Low)
A	Group A (Hold to pair,short press to turn on or off)
B	Group B (Hold to pair,short press to turn on or off)

Color:Black  
Battery:AAA\*2PCS  
Dimension:15\*3.9\*1.4CM